



Taşınabilir enerjide güvenli marka  
Reliable brand in portable energy

# 2025 ORGAZ PRODUCT CATALOGUE



[www.orgaz.com.tr](http://www.orgaz.com.tr)



unicef 

A MEMBER OF  
**WLGA**  
Energy Anywhere



# ORGAZ | LPG EKİPMANLARI



## 30 YILLIK ÜRETİM TECRÜBESİ

30 yılı aşkın tecrübemizle alçak ve yüksek basınç regülatörleri, portatif sobalar, lambalar gibi LPG ile çalışan ekipmanların imalatını yapmaktayız.

## 30 YEARS OF PRODUCTION EXPERIENCE

With more than 30 years of experience, we manufacture LPG powered equipment such as low and high pressure regulators, portable stoves and lamps.



## 74 ÜLKEYE İHRACAT

Müşteri odaklı yaklaşımımızla 74 ülkeye çeşitli markalar altında ürün tedarik etmekteyiz.

## EXPORTS TO 74 COUNTRIES

With our customer-oriented approach, we supply products to 74 countries under various brands.



ORGAZ® alçak ve yüksek basınç regülatörleri, portatif sobalar, brülörler, lambalar, vanalar gibi LPG ile çalışan ekipmanların imalatını yapmaktadır.

Üretim hattımız 3 büyük kıtanın merkezinde yer alan İstanbul'da gerçekleştirildiği için lojistik açıdan hızlı çıkış sağlanmaktadır.

30 yılı aşkın üretim tecrübesine sahip Orgaz, müşteri odaklı yaklaşımıyla 74 ülkeye çeşitli markalar altında ürün tedarik etmektedir.

Bu ülkelerin ulusal standartlarının gerektirdiği ürün sistemleri içerisinde CE ve ISO belgelerine sahip olup, kalite ve zamanında teslimat ana ilkeleridir.

Ürün kalitesi, hammadde girişinden ürün çıkışına kadar her aşamada uygulanan kontrol sistemleri, laboratuvar testleri ve ürünlere yönelik muayene testleri ile sağlanmaktadır.

**"Tüm Bu Ürünlerimizi Avrupa Kalitesinde ve Uzak Doğu Fiyatlarında bulabilirsiniz."**

LPG Ekipmanlarımız ORGAZ ve GASPOWER markaları altında , Kartuş grubu ekipmanı ORCAMP ve CAMPINGMAN markası altında , Tüp emniyet valfleri ORG markası altında , Elektrikli ev aletleri ise ORHOME ve SCHANAL markası altında satılmaktadır.

ORGAZ, İSTANBUL'dadır; Türkiye'nin en büyük ve tarihi sanayi şehridir. Burada 3 havalimanı, uluslararası liman, en ucuz ve en büyük Lojistik avantajları bulunmaktadır.

ORGAZ kalitesi, prestijli onaylarla Türk TSE belgesi, CE Belgeleri CERTY GAS, Pi tarafından TÜV SÜD tarafından onaylanmıştır.

ORGAZ, Türkiye'nin Avrupa Özel Topluluğuna üyeliğinden dolayı müşterilere vergi avantajı sağlayan EUR.1, A.TR EURO-MED sertifikalarının tümünü ürünleri için verebilir.

ORGAZ, tedarikçilerinden biri olan SHV Enerji temsilcisidir. İç pazarda yaygın bir iştirak sistemine sahibiz. Bugün 74 ülkeye ihracat yapıyoruz ve ihracatımız toplam satışlarımızın yaklaşık yüzde 70'ini oluşturmaktadır. Ürünlerimiz ağırlıklı olarak Afrika, Avrupa, Orta Doğu ve Rusya'ya ihraç edilmektedir.



ORGAZ® manufactures LPG-operated equipment such as low- and high-pressure regulators, portable stoves, burners, lamps, valves. Since our production line is carried out in Istanbul, which is located in the center of 3 large continents, fast output is provided in terms of logistics.

With more than 30 years of production experience, Orgaz supplies products under various brands to 74 countries with its customer-oriented approach.

It has CE and ISO certificates within the product systems required by the national standards of these countries, and quality and timely delivery are the main principles.

Product quality is ensured by control systems, laboratory tests and inspection tests for products applied at every stage from raw material entry to product exit.

**"All this products you can find European Quality with the Far East Prices"**

Our LPG Equipment's sold under the ORGAZ and GASPOWER brand names, cartridge group equipment's sold under the ORCAMP and CAMPINGMAN brand names , cylinder safety valves sold under the ORG brand name, home appliances sold under the ORHOME and SCHANAL brand name.

ORGAZ is in İSTANBUL that is; the biggest Industrial and historical city of Turkey. There are 3 airports, international ports, the cheapest and the biggest Logistics advantages.

ORGAZ quality is certified by prestigious approvals as the Turkish TSE, CE Certificates are approved by CERTY GAS , Pi marked by TÜV SÜD.

ORGAZ can give the EUR.1, A.TR EURO-MED, certificate all of their products because of Turkey membership to European Custom Community that gives tax advantage to customers.

ORGAZ is the one of the supplier of which is the representative of SHV Energy. We have a widespread subsidiary system in our domestic market. Today we export to 74 countries, which account for approximately 70% of our total sales. Our products are mainly exported to Africa, Europe, Middle East and Russia.

KARTUŞLU ÜRÜNLER CARTRIDGE EQUIPMENTS	3	PÜR MÜZLER TORCHES	22
SİBOPLU OCAKLAR SAFETY VALVE CARTRIDGE STOVES	4	ISITICILAR VE PİŞİRİCİ RADYANLAR HEATERS AND CERAMIC BURNERS	25
NARGİLE OCAKLAR HOOKAH STOVE	6	KAMP LAMBALARI CAMPING LANTERN	28
KAMP OCAKLAR CAMPING STOVES	7	DEDANTÖRLER REGULATORS	31
PAELLA OCAKLARI PAELLA STOVES	10	HORTUMLAR HOSES	34
SET ÜSTÜ OCAKLAR TABLE COOKERS	11	MUSLUK VE BRÜLÖRLER VALVES AND BURNERS	37
MANGAL & PİŞİRİCİLER BBQ & MULTI COOKING OPTIONS	12	TAV VE KAYNAK TAKIMLARI BLOWTORCHES and WELDING TOOLS	41
KAMP GEREÇLERİ CAMPING EQUIPMENTS	20		



# OCAKLAR

## STOVES

Delinebilir ve Vidalı taşınabilir piknik tüplerinde Bütan ve Propan gaz kartuşları kullanılmaktadır. Modern tasarımı ile kolay taşınması doğa aktivitelerinde konforlu kullanım sağlamaktadır. Uluslararası standartlara uyumlu, zengin ürün yelpazesi.

Drillable and Screwed Orcamp Brand Butane and Propane gas cartridges are used. Easy transportation with its modern design provides comfortable use in nature activities. Rich product range in compliance with international standards.





# KARTUŞLU OCAKLAR CARTRIDGE STOVES



## K-190 KARTUŞ OCAK Cartridge Stove

MAT Metal Body, Chrome Grill and Burner

CONSUMPTION 62,7 <sub>G/H</sub>	POWER 0,8 <sub>KW</sub> /688 <sub>KCAL/H</sub>	NET WTGT 550 <sub>G</sub>
CTN 12 <sub>PCS</sub> / 6,9 <sub>KG</sub>	DIM 410x280x410 <sub>MM</sub>	LOAD 20 DC - 7.680 <sub>PCS</sub> 40 HC - 17.340 <sub>PCS</sub>



## CK-190 ÇAKMAKLI KARTUŞ OCAK Cartridge Stove with Ignition



MAT Metal Body, Chrome Grill and Burner

CONSUMPTION 62,7 <sub>G/H</sub>	POWER 0,8 <sub>KW</sub> /688 <sub>KCAL/H</sub>	NET WTGT 550 <sub>G</sub>
CTN 12 <sub>PCS</sub> / 7,3 <sub>KG</sub>	DIM 410x280x410 <sub>MM</sub>	LOAD 20 DC - 7.680 <sub>PCS</sub> 40 HC - 17.340 <sub>PCS</sub>



## K-191 KARTUŞ OCAK Cartridge Stove

MAT Metal Body, Chrome Grill and Burner

CONSUMPTION 62,7 <sub>G/H</sub>	POWER 0,8 <sub>KW</sub> /688 <sub>KCAL/H</sub>	NET WTGT 600 <sub>G</sub>
CTN 12 <sub>PCS</sub> / 7,7 <sub>KG</sub>	DIM 405x270x410 <sub>MM</sub>	LOAD 20 DC - 7.680 <sub>PCS</sub> 40 HC - 17.340 <sub>PCS</sub>



## CK-191 ÇAKMAKLI KARTUŞ OCAK Cartridge Stove with Ignition

MAT Metal Body, Chrome Grill and Burner

CONSUMPTION 62,7 <sub>G/H</sub>	POWER 0,8 <sub>KW</sub> /688 <sub>KCAL/H</sub>	NET WTGT 600 <sub>G</sub>
CTN 12 <sub>PCS</sub> / 7,7 <sub>KG</sub>	DIM 405x270x410 <sub>MM</sub>	LOAD 20 DC - 7.680 <sub>PCS</sub> 40 HC - 17.340 <sub>PCS</sub>



## PK-190 PLASTİK GÖVDELİ KARTUŞ OCAK Cartridge Stove / Plastic Body

MAT Plastic Body, Chrome Grill and Burner

CONSUMPTION 62,7 <sub>G/H</sub>	POWER 0,8 <sub>KW</sub> /688 <sub>KCAL/H</sub>	NET WTGT 400 <sub>G</sub>
CTN 12 <sub>PCS</sub> / 5,4 <sub>KG</sub>	DIM 410x280x410 <sub>MM</sub>	LOAD 20 DC - 7.680 <sub>PCS</sub> 40 HC - 17.340 <sub>PCS</sub>



## PCK-190 ÇAKMAKLI PLASTİK GÖVDELİ KARTUŞ OCAK Cartridge Stove / Plastic Body / Ignition

MAT Plastic Body, Chrome Grill and Burner

CONSUMPTION 62,7 <sub>G/H</sub>	POWER 0,8 <sub>KW</sub> /688 <sub>KCAL/H</sub>	NET WTGT 500 <sub>G</sub>
CTN 12 <sub>PCS</sub> / 6,68 <sub>KG</sub>	DIM 410x 280x410 <sub>MM</sub>	LOAD 20 DC - 7.680 <sub>PCS</sub> 40 HC - 17.340 <sub>PCS</sub>



## EPK-190 PLASTİK GÖVDELİ EKONOMİK KARTUŞ OCAK Economic Cartridge Stove / Plastic Body

MAT Plastic Body, Chrome Grill and Burner

CONSUMPTION 62,7 <sub>G/H</sub>	POWER 0,8 <sub>KW</sub> /688 <sub>KCAL/H</sub>	NET WTGT 300 <sub>G</sub>
CTN 12 <sub>PCS</sub> / 4,06 <sub>KG</sub>	DIM 350x456x210 <sub>MM</sub>	LOAD 20 DC - 10.080 <sub>PCS</sub> 40 HC - 24.360 <sub>PCS</sub>

Standart Cartridge Housing  
Color Option







# SİBOPLU OCAKLAR

## SAFETY VALVE CARTRIDGE STOVES



### K-502

#### SİBOPLU KARTUŞ OCAK

Safety Valve Cartridge Stove

MAT Chrome Burner and Supports, Brass Valve

CONSUMPTION	POWER	NET WTGT
101,9 <sub>G/H</sub>	1,3 <sub>kw</sub> /1119 <sub>cal/h</sub>	300 <sub>G</sub>
CTN	DIM	
12 <sub>PCS</sub> /14 <sub>KG</sub>	295x360x195 <sub>MM</sub>	



### CK-194

#### ÇAKMAKLI MİKRO OCAK

Micro Stove with Ignition

MAT Chrome Burner and Supports, Brass Valve

CONSUMPTION	POWER	NET WTGT
62,7 <sub>G/H</sub>	0,8 <sub>kw</sub> /688 <sub>cal/h</sub>	250 <sub>G</sub>
CTN	DIM	
12 <sub>PCS</sub> /3,4 <sub>KG</sub>	335x485x165 <sub>MM</sub>	



### K-193

#### SİBOPLU KARTUŞ OCAK

Safety Valve Cartridge Stove



MAT Chrome Burner and Grill, Brass Valve

CONSUMPTION	POWER	NET WTGT
62,7 <sub>G/H</sub>	0,8 <sub>kw</sub> /688 <sub>cal/h</sub>	250 <sub>G</sub>
CTN	DIM	
24 <sub>PCS</sub> /7,24 <sub>KG</sub>	405x280x410 <sub>MM</sub>	



### CK-193

#### ÇAKMAKLI SİBOPLU KARTUŞ OCAK

Valve Cartridge Stove with Ignition



MAT Chrome Burner and Grill, Brass Valve

CONSUMPTION	POWER	NET WTGT
62,7 <sub>G/H</sub>	0,8 <sub>kw</sub> /688 <sub>cal/h</sub>	330 <sub>G</sub>
CTN	DIM	
24 <sub>PCS</sub> /8,80 <sub>KG</sub>	405x280x410 <sub>MM</sub>	



### K-192

#### SİBOPLU KARTUŞ OCAK

Safety Valve Cartridge Stove

MAT Chrome Burner and Grill, Brass Valve

CONSUMPTION	POWER	NET WTGT
62,7 <sub>G/H</sub>	0,8 <sub>kw</sub> /688 <sub>cal/h</sub>	240 <sub>G</sub>
CTN	DIM	
24 <sub>PCS</sub> /6,2 <sub>KG</sub>	405x280x410 <sub>MM</sub>	



### CK-192

#### ÇAKMAKLI SİBOPLU KARTUŞ OCAK

Valve Cartridge Stove with Ignition



MAT Chrome Burner and Grill, Brass Valve

CONSUMPTION	POWER	NET WTGT
62,7 <sub>G/H</sub>	0,8 <sub>kw</sub> /688 <sub>cal/h</sub>	300 <sub>G</sub>
CTN	DIM	
24 <sub>PCS</sub> /7,5 <sub>KG</sub>	405x280x410 <sub>MM</sub>	



### SB-605

#### ISITICI FONKSİYONLU OCAK

Stove with Heater Functional

MAT Chrome Burner and Grill, Brass Valve

CONS	POWER	NET WGT
 112,9g/H	 1,44kW/1239cal/h	 440g
CTN	DIM	
 20 pcs / 9,10kg	 400x550x385mm	



### K-500

#### SİBOPLU KAMP OCAK

Valve Cartridge Stove

MAT Chrome Burner and Grill, Brass Valve

CONS	POWER	NET WGT
 101,9g/H	 1,3kW/1119cal/h	 450g
CTN	DIM	
 12 pcs / 5,86kg	 315x385x400mm	



### KTS-227

227 Gr GAZ KARTUŞU  
227 Gr Gas Cartridge

CTN	DIM	WGT
 24 pcs / 8,2kg	 285x420x215mm	 300g

FEATURES  
227G BAYONET-TYPE GAS CARTRIDGE.  
COMPLIES WITH EN-417.



### KTS-230

230 Gr GAZ KARTUŞU  
230 Gr Gas Cartridge

CTN	DIM	WGT
 24 pcs / 9,5kg	 345x440x205mm	 350g

FEATURES  
LINDAL 7/16 DOUBLE LAYER UNIVERSAL VALVE  
COMPLIES WITH EN-417.



### KTS-450

450 Gr GAZ KARTUŞU  
450 Gr Gas Cartridge

CTN	DIM	WGT
 12 pcs / 8,10kg	 340x240x319mm	 640g

FEATURES  
LINDAL 7/16 DOUBLE LAYER UNIVERSAL VALVE  
COMPLIES WITH EN-417.







# NARGİLE OCAKLAR HOOKAH STOVE



## NO-190 KARTUŞ NARGİLE OCAK Hookah Cartridge Stove

MAT Metal Body, Enamel Coated Grill, Chrome Burner

CONS	POWER	NET WGT
94 G/H	1,2 kW / 1033 kcal/h	780 G
CTN	DIM	LOAD
12 PCS / 9,9 ₺	380x260x565 mm	20 DC - 6,420 PCS 40 HC - 14,580 PCS



## NO-192 SİBOPLU NARGİLE OCAK Hookah Cartridge Stove

MAT Metal Body, Enamel Coated Grill, Chrome Burner

CONS	POWER	NET WGT
94 G/H	1,2 kW / 1033 kcal/h	500 G
CTN	DIM	LOAD
12 PCS / 6,62 ₺	260x380x385 mm	20 DC - 10,800 PCS 40 HC - 24,600 PCS



## NO-194 NARGİLE OCAK Hookah Stove

MAT Metal Body, Enamel Coated Grill, Chrome Burner

CONS	POWER	NET WGT
94 G/H	1,2 kW / 1033 kcal/h	790 G
CTN	DIM	LOAD
12 PCS / 9,74 ₺	575 x 325 x 295 mm	



## ENO-220 ELEKTRİKLİ NARGİLE OCAK Electrical Charcoal Burner

MAT Enameled Coated Body and Grill, S/S Tong

CTN	DIM	NET WGT
12 PCS / 19,05 ₺	365x525x470 mm	1,50 KG

Voltage: 220 - 240V  
Nominal Voltage: 3A  
Frequency: 50 - 60HZ  
Class: 1  
Power: 700W



## NO-191 KARTUŞ NARGİLE OCAK Hookah Cartridge Stove

MAT Metal Body, Enamel Coated Grill, Chrome Burner

CONS	POWER	NET WGT
94 G/H	1,2 kW / 1033 kcal/h	890 G
CTN	DIM	LOAD
12 PCS / 11,16 ₺	330x495x530 mm	20 DC - 3,960 PCS 40 HC - 9,480 PCS



## NO-193 SİBOPLU NARGİLE OCAK Hookah Cartridge Stove

MAT Metal Body, Enamel Coated Grill, Chrome Burner

CONS	POWER	NET WGT
94 G/H	1,2 kW / 1033 kcal/h	1,40 KG
CTN	DIM	LOAD
6 PCS / 8,60 ₺	345x500x310 mm	20 DC - 9,900 PCS 40 HC - 22,500 PCS



## NO-192-US NARGİLE OCAK Hookah Stove

MAT Metal Body, Enamel Coated Grill, Chrome Burner

CONS	POWER	NET WGT
94 G/H	1,2 kW / 1033 kcal/h	500 G
CTN	DIM	LOAD
12 PCS / 6,62 ₺	260x380x385 mm	



## NO-193-US NARGİLE OCAK Hookah Stove

MAT Metal Body, Enamel Coated Grill, Chrome Burner

CONS	POWER	NET WGT
94 G/H	1,2 kW / 1033 kcal/h	1,40 KG
CTN	DIM	LOAD
6 PCS / 8,60 ₺	345x500x310 mm	



# KAMP OCAKLAR CAMPING STOVE



**K-630**  
KAMP OCAK  
Camping Stove

MAT Chrome Body and Burner, Brass Valve

CONS	POWER	NET WGT
184,2 <sub>SH</sub>	2,35 <sub>KW</sub> /2022 <sub>cal/h</sub>	650 <sub>G</sub>
CTN	DIM	LOAD
20 <sub>PCS</sub> /13,45 <sub>KG</sub>	470x470x655 <sub>MM</sub>	20 DC-4.000 <sub>PCS</sub> 40 HC-9.400 <sub>PCS</sub>



**K-635**  
TURBO KAMP OCAK  
Turbo Camping Stove

MAT Chrome Body and Burner, Brass Valve

CONS	POWER	NET WGT
297,8 <sub>SH</sub>	3,8 <sub>KW</sub> /3270 <sub>cal/h</sub>	690 <sub>G</sub>
CTN	DIM	LOAD
20 <sub>PCS</sub> /14,21 <sub>KG</sub>	470x470x655 <sub>MM</sub>	20 DC-4.000 <sub>PCS</sub> 40 HC-9.400 <sub>PCS</sub>



**K-636**  
SÜPER TURBO KAMP OCAK  
Super Turbo Camping Stove

MAT Chrome Body and Burner, Brass Valve

CONS	POWER	NET WGT
278,8 <sub>SH</sub>	3,55 <sub>KW</sub> /3054 <sub>cal/h</sub>	800 <sub>G</sub>
CTN	DIM	LOAD
20 <sub>PCS</sub> /16,9 <sub>KG</sub>	470x470x690 <sub>MM</sub>	20 DC-3.700 <sub>PCS</sub> 40 HC-9.000 <sub>PCS</sub>



**CK-630**  
ÇAKMAKLI KAMP OCAK  
Camping Stove With Ignition

MAT Chrome Body and Burner Brass Valve

CONS	POWER	NET WGT
184,2 <sub>SH</sub>	2,35 <sub>KW</sub> /2022 <sub>cal/h</sub>	700 <sub>G</sub>
CTN	DIM	LOAD
20 <sub>PCS</sub> /14,43 <sub>KG</sub>	470x470x655 <sub>MM</sub>	20 DC-4.000 <sub>PCS</sub> 40 HC-9.400 <sub>PCS</sub>



**CK-635**  
ÇAKMAKLI TURBO KAMP OCAK  
Turbo Camping Stove With Ignition

MAT Chrome Body and Burner Brass Valve

CONS	POWER	NET WGT
297,8 <sub>SH</sub>	3,8 <sub>KW</sub> /3270 <sub>cal/h</sub>	740 <sub>G</sub>
CTN	DIM	LOAD
20 <sub>PCS</sub> /15,15 <sub>KG</sub>	470x470x655 <sub>MM</sub>	20 DC-4.000 <sub>PCS</sub> 40 HC-9.400 <sub>PCS</sub>



**BK-630 / BK-635**  
BLİSTER AMBALAJ KAMP OCAK  
Blister Package Camping Stove

MAT Chrome Body and Burner Brass Valve

CONS	POWER	NET WGT
184,2 <sub>SH</sub>	2,35 <sub>KW</sub> /2022 <sub>cal/h</sub>	650 <sub>G</sub>
CTN	DIM	LOAD
12 <sub>PCS</sub> /9,80 <sub>KG</sub>	605x465x300 <sub>MM</sub>	20 DC-4.200 <sub>PCS</sub> 40 HC-9.960 <sub>PCS</sub>



**K-620**  
MİDİ OCAK  
Midi Stove

MAT Chrome Body and Burner Brass Valve

CONS	POWER	NET WGT
116 <sub>SH</sub>	1,48 <sub>KW</sub> /1273 <sub>cal/h</sub>	400 <sub>G</sub>
CTN	DIM	LOAD
20 <sub>PCS</sub> /9,1 <sub>KG</sub>	400x550x385 <sub>MM</sub>	20 DC-6.700 <sub>PCS</sub> 40 HC-16.100 <sub>PCS</sub>



**EPK-620**  
BOYALI MİDİ OCAK  
Painted Midi Stove

MAT Painted Body and Chrome Burner and Brass Valve

CONS	POWER	NET WGT
116 <sub>SH</sub>	1,48 <sub>KW</sub> /1273 <sub>cal/h</sub>	500 <sub>G</sub>
CTN	DIM	LOAD
20 <sub>PCS</sub> /10,65 <sub>KG</sub>	400x550x385 <sub>MM</sub>	20 DC-15.000 <sub>PCS</sub> 40 HC-125.000 <sub>PCS</sub>

## CONNECTION TYPES



W20-1/14"L



W21,8-1/14"L



G3/8"-19L



G3/8



M10x1



W20-1/14"L





### EPK-630

#### BOYALI KAMP OCAK Painted Camping Stove

MAT Painted Body, Zinc Burner and Zinc Valve

CONS	POWER	NET WGT
184,2 <sub>gH</sub>	2,35 <sub>kw</sub> /2022 <sub>cal/h</sub>	500 <sub>g</sub>
CTN	DIM	LOAD
15 <sub>pcs</sub> / 8,25 <sub>kg</sub> Dormounted Package	230x710x240 <sub>mm</sub>	20 DC - 9.750 <sub>pcs</sub> 40 HC - 23.500 <sub>pcs</sub>



### PK-628

#### MIDI OCAK Midi Stove

MAT Chrome Body, Zinc Burner and Zinc Valve

CONS	POWER	NET WGT
116 <sub>gH</sub>	1,48 <sub>kw</sub> /1273 <sub>cal/h</sub>	700 <sub>g</sub>
CTN	DIM	LOAD
20 <sub>pcs</sub> / 14,43 <sub>kg</sub>	470x470x655 <sub>mm</sub>	20 DC - 51.000 <sub>pcs</sub> 40 HC - 120.000 <sub>pcs</sub>



### K-625

#### MIDI OCAK Midi Stove

MAT Chrome Arm and Burner, Brass Valve

CONS	POWER	NET WGT
116 <sub>gH</sub>	1,48 <sub>kw</sub> /1273 <sub>cal/h</sub>	700 <sub>g</sub>
CTN	DIM	LOAD
20 <sub>pcs</sub> / 14,43 <sub>kg</sub>	470x470x655 <sub>mm</sub>	



### K-626

#### MIDI OCAK Midi Stove

MAT Chrome Arm and Burner, Brass Valve

CONS	POWER	NET WGT
116 <sub>gH</sub>	1,48 <sub>kw</sub> /1273 <sub>cal/h</sub>	700 <sub>g</sub>
CTN	DIM	LOAD
20 <sub>pcs</sub> / 14,43 <sub>kg</sub>	470x470x655 <sub>mm</sub>	



### G-610/7

#### KAMP OCAK VE BRÜLÖR VALF TAKIM Camping Stove with Valve Burner Set

MAT Painted Body, Chrome Burner and Brass Valve

CONS	POWER	NET WGT
297,8 <sub>gH</sub>	3,8 <sub>kw</sub> /3270 <sub>cal/h</sub>	300 <sub>g</sub>
CTN	DIM	LOAD
50 <sub>pcs</sub> / 15,77 <sub>kg</sub>	575x245x560 <sub>mm</sub>	



### G-610/1

#### KAMP OCAK VE METAL HORTUM SET Camping Stove with Metal Hose Set

MAT Painted Body, Chrome Burner and Brass Valve

CONS	POWER	NET WGT
297,8 <sub>gH</sub>	3,8 <sub>kw</sub> /3270 <sub>cal/h</sub>	300 <sub>g</sub>
CTN	DIM	LOAD
50 <sub>pcs</sub> / 15,77 <sub>kg</sub>	575x245x560 <sub>mm</sub>	



### KB-636

#### KROM KÜÇÜLTÜCÜ Chrome Grid

CTN	DIM	WGT
250 <sub>pcs</sub> / 13,45 <sub>kg</sub>	405x270x410 <sub>mm</sub>	50 <sub>g</sub>

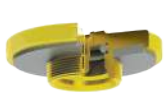

7/16"-28NEF



M16x1,5



M14x1,25



M14x1,25



G3/8



M14x1,5



# BURNER AND VALVE

## VALVE ET BRÛLEUR B630



**B-630**  
VALF BRÛLÖR TAKIM  
Valf Burner Set

MAT Brass Valve, Chrome Burner, Metal or Plastic Knob

CONS	POWER	NET WGT
184,2g/h	2,35kW/2022kcal/h	150g
CTN	DIM	LOAD
100 PCS / 19,910kg	520x225x470mm	20 DC-54.000PCS 40 HC-125.000PCS



**B-800**  
VALF BRÛLÖR TAKIM  
Super Valve Burner Set

MAT Brass Valve, Chrome Burner, Metal Knob

CONS	POWER	NET WGT
3,5527g/h	2,35kW/2022kcal/h	200g
CTN	DIM	LOAD
100 PCS / 25,70kg	560x225x470mm	



**G-300**  
TRİVET IZGARA  
Trivet Grill

MAT Metal Painted Body

CTN	DIM	NET WGT
6 PCS / 10,50kg	685x350x335mm	1,65kg



**G-270**  
TRİVET GRILL  
Trivet Grill

MAT Metal Painted Body

CTN	DIM	NET WGT
10 PCS / 7,7kg	325x325x315mm	700g



**GR-813**  
BRÛLÖRLÜ IZGARA  
Grill with Burner

MAT Metal Painted Body

CONS	POWER	NET WGT
184,2g/h	2,35kW/2022kcal/h	1,05kg
CTN	DIM	LOAD
20 PCS / 22,10kg	510x775x375mm	



**KA-402**  
İKİLİ SANAYİ OCAK  
Two Burner Cast Iron Body Stove

MAT Metal Body Shaped Tube, Cast Iron Burner

CONS	POWER	NET WGT
1200g/h	15,4kW/13200kcal/h	15kg
CTN	DIM	LOAD
1 PCS	360x820x260mm	



**VL-400**  
KARE VOLKAN OCAK  
Square Cast Iron Body Stove

MAT Metal Body Shaped Tube, Cast Iron Burner

CONS	POWER	NET WGT
1200g/h	15,4kW/13200kcal/h	4,24kg
CTN	DIM	SIZE
1 PCS	325x310x105mm	35x35-22CM



**VL-401**  
KARE VOLKAN OCAK  
Square Cast Iron Body Stove

MAT Metal Body, Cast Iron Burner

CONS	POWER	NET WGT
1200g/h	15,4kW/13200kcal/h	4,10kg
CTN	DIM	SIZE
1 PCS	410x408x130mm	40x40-16CM



**VL-402**  
EKO VOLKAN OCAK  
Eco Square Cast Iron Body Stove

MAT Metal Body Shaped Tube, Cast Iron Burner

CONS	POWER	NET WGT
278,8g/h	3,55kW/3054kcal/h	1,5kg
CTN	DIM	SIZE
1 PCS	305x305x52mm	32x32-14CM





# PAELLA OCAKLARI PAELLA STOVES



**MOD-200**  
Ø20CM TEKİLİ PAELLA OCAK  
Ø20cm Single Paella Burner

MAT Enameled Burner

POWER	NET WGT	CTN
5,5kW	1,2kg	10 PCS / 13,67kg
DIM	LOAD	
340x440x330mm	20 DC-6.255PCS 40 HC-14.000PCS	



**MOD-300**  
Ø30CM TEKİLİ PAELLA OCAK  
Ø30cm Single Paella Burner

MAT Enameled Burner

POWER	NET WGT	CTN
6,5kW	1,5kg	10 PCS / 21,85kg
DIM	LOAD	
505x615x335mm	20 DC-6.255PCS 40 HC-14.000PCS	



**MOD-300 DUAL**  
Ø30CM İKİLİ PAELLA OCAK  
Ø30cm Dual Paella Burner

MAT Enameled Burner

POWER	NET WGT	CTN
7,5kW	1,95kg	10 PCS / 21,85kg
DIM	LOAD	
505x615x335mm	20 DC-3.300PCS 40 HC-9.000PCS	



**MOD-350**  
Ø35CM İKİLİ PAELLA OCAK  
Ø35cm Dual Paella Burner

MAT Enameled Burner

POWER	NET WGT	CTN
9,1kW	2kg	10 PCS / 21,85kg
DIM	LOAD	
590x615x335mm	20 DC-2.600PCS 40 HC-8.000PCS	



**MOD-400**  
Ø40CM İKİLİ PAELLA OCAK  
Ø40cm Dual Paella Burner

MAT Enameled Burner

POWER	NET WGT	CTN
11,4kW	2,40kg	10 PCS / 25,50kg
DIM	LOAD	
640x340x740mm	20 DC-2.000PCS 40 HC-7.000PCS	



**MOD-500**  
Ø50CM İKİLİ PAELLA OCAK  
Ø50cm Dual Paella Burner

MAT Enameled Burner

POWER	NET WGT	CTN
14,1kW	2,9kg	5 PCS / 16,32kg
DIM	LOAD	
520x750x350mm	20 DC-1.500PCS 40 HC-5.500PCS	



**MOD-600**  
Ø60CM ÜÇLÜ PAELLA OCAK  
Ø60cm Triple Paella Burner

MAT Enameled Burner

POWER	NET WGT	CTN
21kW	4,25kg	1 PCS
DIM	LOAD	
630x900x135mm	20 DC-1.050PCS 40 HC-3.250PCS	



**MOD-700**  
Ø70CM ÜÇLÜ PAELLA OCAK  
Ø70cm Triple Paella Burner

MAT Enameled Burner

POWER	NET WGT	CTN
24,1kW	4,90kg	1 PCS
DIM	LOAD	
700x990x135mm	20 DC-800PCS 40 HC-2.250PCS	





## SET ÜSTÜ OCAKLAR TABLE COOKERS



### OR-110

TEKLİ SET ÜSTÜ OCAK  
Table Cooker with One Burner

MAT Metal Painted Body, S/S Burner

CONSUMPTION 70,5 <sup>g/h</sup>	POWER 0,9 <sup>kw</sup> /774 <sup>cal/h</sup>	NET WT 1,42 <sup>kg</sup>
CTN 1 <sup>pcs</sup>	DIM 110x275x255 <sup>mm</sup>	LOAD 20 DC-3.750 <sup>pcs</sup> 40 HC-8.915 <sup>pcs</sup>



### OR-210

İKİLİ SET ÜSTÜ OCAK  
Table Cooker with Two Burner

MAT Metal Painted Body, S/S Burner

CONSUMPTION 148,9x2 <sup>g/h</sup>	POWER 1,9x2 <sup>kw</sup> /1635x2 <sup>cal/h</sup>	NET WT 2,56 <sup>kg</sup>
CTN 1 <sup>pcs</sup>	DIM 110x555x255 <sup>mm</sup>	LOAD 20 DC-1.850 <sup>pcs</sup> 40 HC-4.410 <sup>pcs</sup>



### OR-310

ÜÇLÜ SET ÜSTÜ OCAK  
Table Cooker with Three Burner

MAT Metal Painted Body, S/S Burner

CONSUMPTION 70,5-148,9x2 <sup>g/h</sup>	POWER 0,9-1,9x2 <sup>kw</sup> /774-1635x2 <sup>cal/h</sup>	NET WT 3,30 <sup>kg</sup>
CTN 1 <sup>pcs</sup>	DIM 335x90x635 <sup>mm</sup>	LOAD 20 DC-1.500 <sup>pcs</sup> 40 HC-3.600 <sup>pcs</sup>



### OR-101

TEKLİ SET ÜSTÜ OCAK  
Table Cooker with One Burner

MAT Metal Painted Body, Enamel Burner

CONSUMPTION B 164,6 <sup>g/h</sup>	POWER B 2,10 <sup>kw</sup> 1807 <sup>cal/h</sup>	NET WT 1,82 <sup>kg</sup>
CTN 1 <sup>pcs</sup>	DIM 85x305x365 <sup>mm</sup>	LOAD 20 DC-2.250 <sup>pcs</sup> 40 HC-5.340 <sup>pcs</sup>



### OR-201

İKİLİ SET ÜSTÜ OCAK  
Table Cooker with Two Burner

MAT Metal Painted Body, Enamel Burner

CONSUMPTION M 109,7 <sup>g/h</sup> B 164,6 <sup>g/h</sup>	POWER M 1,40 <sup>kw</sup> 1205 <sup>cal/h</sup> B 2,10 <sup>kw</sup> 1807 <sup>cal/h</sup>	NET WT 2,82 <sup>kg</sup>
CTN 1 <sup>pcs</sup>	DIM 85x305x500 <sup>mm</sup>	LOAD 20 DC-1.900 <sup>pcs</sup> 40 HC-4.600 <sup>pcs</sup>



### OR-301

ÜÇLÜ SET ÜSTÜ OCAK  
Table Cooker with Three Burner

MAT Metal Painted Body, Enamel Burner

CONSUMPTION S 74,5 <sup>g/h</sup> M 109,7 <sup>g/h</sup> B 164,6 <sup>g/h</sup>	POWER S 0,95 <sup>kw</sup> 817 <sup>cal/h</sup> M 1,40 <sup>kw</sup> 1205 <sup>cal/h</sup> B 2,10 <sup>kw</sup> 1807 <sup>cal/h</sup>	NET WT 4,15 <sup>kg</sup>
CTN 1 <sup>pcs</sup>	DIM 85x380x620 <sup>mm</sup>	LOAD 20 DC-1.400 <sup>pcs</sup> 40 HC-3.400 <sup>pcs</sup>



### OR-401

DÖRTLÜ SET ÜSTÜ OCAK  
Table Cooker with Four Burner

MAT Metal Painted Body, Enamel Burner

CONSUMPTION S 74,5 <sup>g/h</sup> M 2x109,7 <sup>g/h</sup> B 164,6 <sup>g/h</sup>	POWER S 0,95 <sup>kw</sup> 817 <sup>cal/h</sup> M 1,40 <sup>kw</sup> 2x1205 <sup>cal/h</sup> B 2,10 <sup>kw</sup> 1807 <sup>cal/h</sup>	NET WT 5,43 <sup>kg</sup>
CTN 1 <sup>pcs</sup>	DIM 133x513x566 <sup>mm</sup>	LOAD 20 DC-1.150 <sup>pcs</sup> 40 HC-2.850 <sup>pcs</sup>



## MANGAL & PİŞİRİCİLER

### BBQ & MULTI COOKING OPTIONS

Konforunuz için, yaratıcı ve pratik çözüm. Kolay kurulum ve taşınabilirlik. Güvenilir gıda emayesi ile kaplanmış ızgara, homojen ısı dağılımı veren patentli özel brülör ile lezzetli mangal keyfinizi sağlar.

Creative and practical solution for your comfort. Easy installation and portability. The grill, coated with reliable food enamel, provides your delicious barbecue pleasure with a patented special burner that gives homogeneous heat distribution.

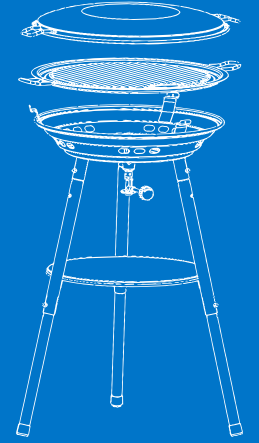



## ÇOK AMAÇLI SÜPER OCAKLAR MULTI-PURPOSE SUPER STOVE



### GR-823

#### ÜÇ AYAKLI ÇOK AMAÇLI SÜPER OCAK Tripot Multi Purpose Super Stove

MAT Painted Body, Chrome Burner, Brass Valve, Enamel or Teflon Grills Options

CONS 278,8<sub>Wh</sub>

POWER 3,55<sub>kW</sub>/3054<sub>kcal/h</sub>

NET WGT 4<sub>kg</sub>

CTN 4<sub>PCS</sub> / 16,35<sub>kg</sub>

DIM 410x620x405<sub>mm</sub>

#### \*Gas Connection Options / Gaz Bağlantı Seçenekleri



7/16 Universal Gas Cartridge



M40 - 009 Adapter



AK - 190 Adapter Set

#### \*Optional Accessories / Opsiyonel Aksesuarlar



### GR-823-60

EMAYE VEYA YAPIŞMAZ GRANİT KAPLAMALI  
Enamel Or Non-Stick Granite Coated.  
Ø 40 cm



### GR-823-40

YAPIŞMAZ GRANİT KAPLAMA  
Non - Stick Granite Coated.  
Ø 40 cm



### GR-823-40

EMAYE VEYA YAPIŞMAZ GRANİT KAPLAMALI  
Enamel Or Non-Stick Granite Coated.  
Ø 40 cm



TAŞIMA ÇANTASI.  
Carry Bag.



### GR-918

#### TRİPOT ÇOK AMAÇLI SÜPER MANGAL Tripot Multi Purpose Super Grill

MAT Painted Body, Chrome Burner, Brass Valve, Enamel or Teflon Grills Options

CONS 278,8<sub>Wh</sub>

POWER 3,55<sub>kW</sub>/3054<sub>kcal/h</sub>

NET WGT 4,25<sub>kg</sub>

CTN 2<sub>PCS</sub> / 8,69<sub>kg</sub>

DIM 330x485x550<sub>mm</sub>

#### \*Gas Connection Options / Gaz Bağlantı Seçenekleri



#### \*Optional Accessories / Opsiyonel Aksesuarlar



EMAYE VEYA YAPIŞMAZ GRANİT KAPLAMALI  
Enamel Or Non-Stick Granite Coated.  
Ø 40 cm



EMAYE VEYA YAPIŞMAZ GRANİT KAPLAMALI  
Enamel Or Non-Stick Granite Coated.  
Ø 40 cm



TAŞIMA ÇANTASI.  
Carry Bag.

### GR-820

#### ÇOK AMAÇLI SÜPER OCAK Multi Purpose Super Stove

MAT Painted Body, Chrome Burner, Brass Valve, Enamel or Teflon Grills Options

CONS 180,3<sub>Wh</sub>

POWER 2,30<sub>kW</sub>/1979<sub>kcal/h</sub>

NET WGT 3,2<sub>kg</sub>

CTN 4<sub>PCS</sub> / 13,2<sub>kg</sub>

DIM 410x620x405<sub>mm</sub>









## K-629 KATLANABİLİR İKİLİ KAMP OCAK Foldable Two Burner Camping Stove

MAT Painted Body, Chrome Burner, Brass Valve

CONS  2x295<sup>cm</sup> POWER  2x3,8<sup>kW</sup>/3260<sup>cal/h</sup> NET WGT  3,3<sup>kg</sup>



CTN  2<sup>pcs</sup> / 6,83<sup>kg</sup> DIM  285x545x360<sup>mm</sup>



## K-629-1 İKİLİ YER TİPİ KAMP OCAK Ground Type Two Burner Camping Stove

MAT Painted Body, Chrome Burner, Brass Valve

CONS  2x295<sup>cm</sup> POWER  2x3,8<sup>kW</sup>/3260<sup>cal/h</sup> NET WGT  3,3<sup>kg</sup>

CTN  2<sup>pcs</sup> / 6,83<sup>kg</sup> DIM  285x545x360<sup>mm</sup>

### \*Gas Connection Options / Gaz Bağlantı Seçenekleri



### \*Optional Accessories / Opsiyonel Aksesuarlar



ALÜMİNYUM GRANİT IZGARA  
Aluminum Granite Grill



TAŞIMA ÇANTASI  
Carry Bag.



## YENİ ÜRÜN NEW PRODUCT



Operates with 227g bayonet-type gas cartridges, ensuring convenient and portable use.



Designed for compatibility with 7/16 threaded gas cartridges, offering reliable and efficient performance.





Paslanmaz barbekü, Kartuş tüp bağlantılı

Stainless, Any EN417 7/16"x27 UNEF threaded gas cartridge (direct pressure)

## ORM-6 Marin Tip Barbekü Marine Grill

Dünyada en yaygın  
kullanılan şık marin  
tip barbekü

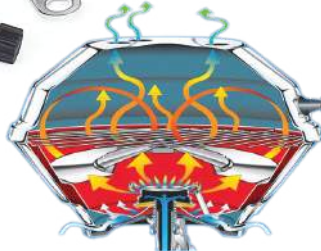

## ORM-6 MARİN TİP BARBEKÜ Marin Grill

MAT Stainless Steel Body and Grill, Brass Valve

CONS   
278,8g/m

POWER   
3,55kW/3054kcal/h

NET WTGT   
6,35kg

CTN   
1PCS

DIM   
515x450x280mm









## ORM-5 TRİPOD AYAKLI MANGAL

Tripod Stand BBQ

MAT Painted Body, Stainless Steel Grill, Chrome Burner

CONS	POWER	NET WT
		
278,8 <sup>G/H</sup>	3,55 <sup>KW</sup> /3054 <sup>Kcal/h</sup>	6,35 <sup>KG</sup>
CTN	DIM	
		
1 <sup>PCS</sup>	515x450x280 <sup>MM</sup>	



## ORM-5-1 TÜP ÜSTÜ PREMIUM MANGAL

Top Premium Grill

MAT Painted Body, Stainless Steel Grill, Chrome Burner

CONS	POWER	NET WT
		
278,8 <sup>G/H</sup>	3,55 <sup>KW</sup> /3054 <sup>Kcal/h</sup>	6,35 <sup>KG</sup>
CTN	DIM	
		
1 <sup>PCS</sup>	515x450x280 <sup>MM</sup>	

### \*Product Details / Ürün Detayları



YAĞ KABI  
Oilcan



PASLANMAZ ÇELİK IZGARA  
Stainless Steel Grill



KROM GÜÇLÜ BRÜLÖR  
Powerfull Chrome Burner

### \*Gas Connection Options / Gaz Bağlantı Seçenekleri



DOĞRUDAN TÜP BAĞLANTISI  
Direct Cylinder Connection



METAL HORTUM BAĞLANTISI  
Metal Hose Connector





## GR-914 TÜP ÜSTÜ KATMER SAC Tupe Grill

MAT Painted Body, Chrome Burner, Brass Valve,  
Enamel or Teflon Grills Options

CONS  
278,8<sub>g/h</sub>

POWER  
3,55<sub>kW</sub>/3054<sub>kcal/h</sub>

NET WGT  
6,10<sub>KG</sub>

CTN  
2<sub>PCS</sub> / 12,26<sub>KG</sub>

DIM  
340x460x565<sub>MM</sub>

### Optional Accessory / Opsiyonel Aksesuarlar



EMAYE VEYA YAPIŞMAZ GRANİT  
KAPLAMALI  
Enamel Or Non-Stick Granit Coated.  
Ø 40 cm



EMAYE VEYA YAPIŞMAZ GRANİT  
KAPLAMALI  
Enamel Or Non-Stick Granit Coated.  
Ø 40 cm



TAŞIMA ÇANTASI.  
Carry Bag.

### \*Product Details / Ürün Detayları



## GR-917 TÜP ÜSTÜ KATMER SAC Tupe Grill

MAT Painted Body, Chrome Burner, Brass Valve,  
Enamel or Teflon Grills Options

CONS  
278,8<sub>g/h</sub>

POWER  
3,55<sub>kW</sub>/3054<sub>kcal/h</sub>

NET WGT  
6,10<sub>KG</sub>

CTN  
2<sub>PCS</sub> / 12,26<sub>KG</sub>

DIM  
340x460x565<sub>MM</sub>

### \*Optional Accessory / Opsiyonel Aksesuarlar



EMAYE VEYA YAPIŞMAZ GRANİT  
KAPLAMALI  
Enamel Or Non-Stick Granit Coated.  
Ø 40 cm



EMAYE VEYA YAPIŞMAZ GRANİT  
KAPLAMALI  
Enamel Or Non-Stick Granit Coated.  
Ø 40 cm



TAŞIMA ÇANTASI.  
Carry Bag.







### SB-645

#### MINİ ŞİŞ - DÖNER MAKİNASI ( ELEKTRİK MOTORLU 220 V ) Shawarma - Shashlik Grill ( Electrical Rotisserie Motor 220 V )

MAT Stainless Steel Body

CONS  352<sub>Gr/h</sub>

POWER  3,15<sub>kWh</sub>/3500<sub>kcal/h</sub>

NET WGT  8,18<sub>KG</sub>

CTN  1<sub>PCS</sub>

DM  340x400x200<sub>MM</sub>

FEATURES  
Powerfull Ceramic Radian Burner.  
Ø 30 cm Cooking Area.  
Gas Type: Butan-Propane (LPG)  
Operation Pressure: - 50 mbar  
High Quality Stainless Steel Body  
240V - 4Kw



### SB-645

#### MINİ ŞİŞ - DÖNER MAKİNASI ( PİLLİ MOTORLU ) Shawarma - Shashlik Grill ( Battery Rotisserie Motor )

MAT Stainless Steel Body

CONS  352<sub>Gr/h</sub>

POWER  3,15<sub>kWh</sub>/3500<sub>kcal/h</sub>

NET WGT  8,18<sub>KG</sub>

CTN  1<sub>PCS</sub>

DM  340x400x200<sub>MM</sub>

FEATURES  
Powerfull Ceramic Radian Burner.  
Ø 30 cm Cooking Area.  
Gas Type: Butan-Propane (LPG)  
Operation Pressure: - 50 mbar  
High Quality Stainless Steel Body



ELEKTRİK MOTORLU 220 V  
Electrical Rotisserie Motor 220 V



PİLLİ MOTORLU  
Battery Rotisserie Motor



KATLANABİLİR  
Foldable



TAŞIMA ÇANTALI  
Carry Bag.



## GR-832

### TEFLON KREP TAVASI Crepe Pan

MAT Painted Body, S/S Grill, Chrome Burner

CONS  
180,3<sup>g</sup>H

POWER  
2,3<sup>kw</sup>/1979<sup>kcal/h</sup>

NET WGT  
4,75<sup>kg</sup>

CTN  
1<sup>PCS</sup>

DIM  
560x555x225<sup>mm</sup>



## GR-832

### GAZLI PANKEK TAVASI Pancake Maker

MAT Painted Body, S/S Grill, Chrome Burner

CONS  
180,3<sup>g</sup>H

POWER  
2,3<sup>kw</sup>/1979<sup>kcal/h</sup>

NET WGT  
4,75<sup>kg</sup>

CTN  
1<sup>PCS</sup>

DIM  
560x555x225<sup>mm</sup>



## GR-830

### TÜP ÜSTÜ YUFKA SACI Tube Grill

MAT Painted Body, S/S Grill, Chrome Burner

CONS  
180,3<sup>g</sup>H

POWER  
2,3<sup>kw</sup>/1979<sup>kcal/h</sup>

NET WGT  
4,75<sup>kg</sup>

CTN  
1<sup>PCS</sup>

DIM  
560x555x225<sup>mm</sup>

Gıda emayesi ile sağlıklı pişirme sağlayan pişirme sacı, özel brülörü ile homojen ısı dağılımı sağlar.

Special burner and food enameled coverage gives, healthy food and homogeneous heat all side of the grill.







## KAMP GEREÇLERİ CAMPING EQUIPMENTS



**OUT-4260**  
ATEŞ ÇUKURU BARBEKÜ  
Portable BBQ Grill



1 PCS



360x250x205<sub>MM</sub>



4,62<sub>KG</sub>



**G-386**  
ATEŞ ÜSTÜ ŞİŞ / PİLİÇ ÇEVİRME  
Portable Compact Grill and Shashlik



1 PCS



387x224x300<sub>MM</sub>



2,28<sub>KG</sub>



**G-388**  
ATEŞ ÜSTÜ ŞİŞ / PİLİÇ ÇEVİRME  
S/S Portable Compact Grill and Shashlik



1 PCS



387x224x300<sub>MM</sub>



2,17<sub>KG</sub>



**G-385**  
BOYALI ATEŞ ÜSTÜ IZGARA  
Painted Foldable Campfire Grill



1 PCS



387x224x160<sub>MM</sub>



1,54<sub>KG</sub>



**G-387**  
PASLANMAZ ATEŞ ÜSTÜ IZGARA  
S/S Foldable Campfire Grill



1 PCS



387x224x160<sub>MM</sub>



1,53<sub>KG</sub>



**G-170**  
ATEŞ KUTUSU  
Fire Box



6 PCS



210x245x200<sub>MM</sub>



600<sub>KG</sub>



**G-380**  
AYAKLI KAVURMA SACI  
Tripod Roasting Sheet



1 PCS



560x460x90<sub>MM</sub>



2,13<sub>KG</sub>



**G-330**  
ATEŞ ÜSTÜ PASLANMAZ  
ŞİŞ APARATI  
S/S, BBQ Skewer Rack



6 PCS



520x360x240<sub>MM</sub>



500<sub>KG</sub>



**G-360**  
ÜÇGEN  
KATLANIR OCAK  
Triangle Folding Hob



1 PCS



360x360x360<sub>MM</sub>



1,290<sub>KG</sub>



## OUT-2250

### KATLANABİLİR YAN MASALI SANDALYE Folding Side Table Camping Chair

CTN   
6 PCS

DIM   
360x360x360<sub>MM</sub>

WGT   
1,29<sub>KG</sub>



## G-590

### TROVE AKILLI IZGARA Trove Smarter Grill

CTN   
1 PCS

DIM   
590x385x50<sub>MM</sub>

WGT   
6,55<sub>KG</sub>



## G-591

### TROVE AKILLI IZGARA Trove Smarter Grill

CTN   
1 PCS

DIM   
590x385x50<sub>MM</sub>

WGT   
12<sub>KG</sub>



## DS-270

### DOĞA ŞÖMİNE Fire Pit

CTN   
1 PCS

DIM   
Ø270/360<sub>MM</sub>

WGT   
4,22<sub>KG</sub>



## DS-340

### DOĞA ŞÖMİNE Fire Pit

CTN   
1 PCS

DIM   
Ø240/420<sub>MM</sub>

WGT   
4,58<sub>KG</sub>



## RZ-306

### RÜZGARLIK Wind Screen

HIGH   
300<sub>CM</sub>

WIDTH   
120

NO-W   
6



## RZ-556

### RÜZGARLIK Wind Screen

HIGH   
550<sub>CM</sub>

WIDTH   
160

NO-W   
6



## RZ-559

### RÜZGARLIK Wind Screen

HIGH   
550<sub>CM</sub>

WIDTH   
160

NO-W   
9



# PÜRMÜZLER

## TORCHES

### METAL PLASTİK GÖVDELİ KARTUŞ PÜRMÜZLER

#### METAL AND PLASTIC BODY BLOWTORCHES

Delinebilir ve Vidalı Orcamp Marka Butan ve Propan gaz kartuşları kullanılmaktadır. Modern tasarımı ile kolay taşınması doğa aktivitelerinde konforlu kullanım sağlamaktadır. Cihaz kapalı olmadan ve bitmeden asla kartuş tüpünü yerinden çıkarmayınız.

Drillable and Screwed Orcamp Brand Butane and Propane gas cartridges are used. Easy transportation with its modern design provides comfortable use in nature activities. Never remove the cartridge tube before the device is turned off and finished.

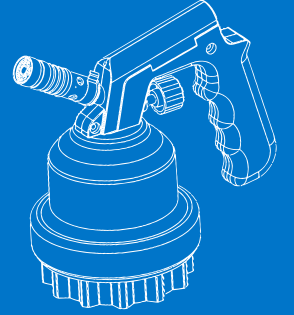



# PÜR MÜZLER TORCHES

Standart Cartridge Housing  
Color Option



**X-190**  
KARTUŞ PÜR MÜZ  
Cartridge Torch

MAT	Metal Body, Plastic Handle	
CONS	170 G/H	2,2 kW / 1900 kcal/h
POWER		
NET WGT	650 g	
CTN	12 PCS / 8,29 ₺	
DIM	400x380x455 MM	
LOAD	20 DC - 4,920 PCS 40 HC - 11,880 PCS	



**CX-190**  
ÇAKMAKLI KARTUŞ PÜR MÜZ  
Cartridge Torch with Ignition

MAT	Metal Body, Plastic Handle	
CONS	170 G/H	2,2 kW / 1900 kcal/h
POWER		
NET WGT	700 g	
CTN	12 PCS / 9,39 ₺	
DIM	400x380x455 MM	
LOAD	20 DC - 4,920 PCS 40 HC - 11,880 PCS	



**XU-190**  
UZUN BOYUNLU KARTUŞ PÜR MÜZ  
Cartridge Torch with Long Burner

MAT	Metal Body, Plastic Handle	
CONS	170 G/H	2,2 kW / 1900 kcal/h
POWER		
NET WGT	750 g	
CTN	12 PCS / 9,96 ₺	
DIM	350x456x210 MM	
LOAD	20 DC - 4,920 PCS 40 HC - 11,880 PCS	



**EPX-190**  
EKO KARTUŞ PÜR MÜZ  
Eco Cartridge Torch with Plastic Body

MAT	Plastic Body, Plastic Handle	
CONS	170 G/H	2,2 kW / 1900 kcal/h
POWER		
NET WGT	420 g	
CTN	12 PCS / 5,7 ₺	
DIM	400x380x455 MM	
LOAD	20 DC - 4,920 PCS 40 HC - 11,880 PCS	



**PX-190**  
KARTUŞ PÜR MÜZ  
Cartridge Torch with Plastic Body

MAT	Plastic Body, Plastic Handle	
CONS	170 G/H	2,2 kW / 1900 kcal/h
POWER		
NET WGT	500 g	
CTN	12 PCS / 6,75 ₺	
DIM	400x380x445 MM	
LOAD	20 DC - 4,920 PCS 40 HC - 11,880 PCS	



**PCX-190**  
ÇAKMAKLI KARTUŞ PÜR MÜZ  
Cartridge Torch with Ignition

MAT	Plastic Body, Plastic Handle	
CONS	170 G/H	2,2 kW / 1900 kcal/h
POWER		
NET WGT	550 g	
CTN	12 PCS / 7,36 ₺	
DIM	400x380x445 MM	
LOAD	20 DC - 4,920 PCS 40 HC - 11,880 PCS	



**XU-193**  
VİDALI SİBOPLU PÜR MÜZ  
Valve Cartridge Torch  
(for 227g gas cartridge)

MAT	Brass Valve, S/S Burner	
CONS	170 G/H	2,2 kW / 1900 kcal/h
POWER		
NET WGT	500 g	
CTN	12 PCS / 6,75 ₺	
DIM	400x380x445 MM	
LOAD	20 DC - 4,920 PCS 40 HC - 11,880 PCS	



**X-193**  
GEÇME TÜPLÜ PÜR MÜZ  
Valve Gas Cartridge Torch

MAT	Brass Valve, S/S Burner	
CONS	170 G/H	2,2 kW / 1900 kcal/h
POWER		
NET WGT	550 g	
CTN	12 PCS / 7,36 ₺	
DIM	400x380x445 MM	
LOAD	20 DC - 4,920 PCS 40 HC - 11,880 PCS	



**CX-500+KTS-227**  
PÜR MÜZ SET  
Torch Set with 227gr Gas Cartridge

MAT	Brass Valve, S/S Burner	
CONS	80 G/H	1 kW / 1900 kcal/h
POWER		
NET WGT	450 g	
CTN	12 PCS / 7,36 ₺	
DIM	400x380x445 MM	
LOAD	20 DC - 4,920 PCS 40 HC - 11,880 PCS	



## CX-194 YABANI OT YAKMA PÜRMÜZÜ Weed Burner

MAT	Brass Valve, Metal Burner	
CONS	228 G/H	POWER 3,6 kW / 2900 kcal/h
NET WGT	900 G	
CTN	12 PCS / 11,02 KG	DIM 345x900x310 MM



## X-192 SİBOPLU PÜRMÜZ Valve Gas Cartridge Torch

MAT	Brass Valve, S/S Burner	
CONS	170 G/H	POWER 2,2 kW / 1900 kcal/h
NET WGT	550 G	
CTN	12 PCS / 7,36 KG	DIM 400x380x445 MM
LOAD	20 DC - 4,920 PCS 40 HC - 11,880 PCS	



## XM-192 SİBOPLU PÜRMÜZ Valve Gas Cartridge Torch

MAT	Brass Valve, Metal Burner	
CONS	170 G/H	POWER 2,2 kW / 1900 kcal/h
NET WGT	0,60 KG	
CTN	12 PCS / 7,75 KG	DIM 400x380x455 MM



## YAK-400 YAK - YAK TAKIM Yak Yak Set

MAT	Brass Valve, Metal Burner, Hose	
CONS	170 G/H	POWER 2,2 kW / 1900 kcal/h
NET WGT	600 G	
CTN	12 PCS / 7,75 KG	DIM 400x380x455 MM



## BUN-100 BUNSEN LAB BRÜLÖR Bunsen Lab Burner

MAT	Brass Valve, Chrome Burner	
CONS	192 G/H	POWER 2,45 kW



## BUN-101 BUNSEN LAB BRÜLÖR 7/16 Bunsen Lab Burner 7/16

MAT	Brass Valve, Chrome Burner	
CONS	192 G/H	POWER 2,45 kW



## BUN-102 BUNSEN KARTUŞLU LAB BRÜLÖR Bunsen Lab Burner

MAT	Meral Body, Brass Valve, Chrome Burner	
CONS	192 G/H	POWER 2,45 kW



## ISITICILAR VE PIŞİRİCİ RADYANLAR HEATERS AND CERAMIC BURNERS

Farklı standartlardaki tüplerde kullanılabilir soba seçenekleri ile doğa aktivitelerinde, açık alan ısıtmasında kolay çözümler üretir. Kolay taşınabilir ve saklanır, ekonomik gaz tüketimi ile tercihinizdir. Döner ocaklarınızda kaliteli yedek parça imkanı edebilirsiniz.

With stove options that can be used in cylinders of different standards, you can use them in nature activities, outdoor areas produces easy solutions for heating. Easy to carry and store, it is your choice with economical gas consumption. You get quality spare parts for your rotary cookers.

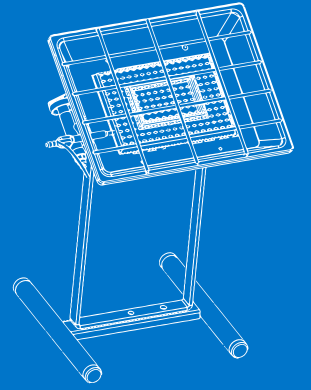





## ISITICILAR VE PIŞİRİCİ RADYANLAR HEATERS AND CERAMIC BURNERS



### SB-600 KAMP SOBA Camping Heater

MAT	Metal Body, Zinc Valve, Regulator, Ceramic Burner		
CONS	112,9 <sub>G/H</sub>	1,44 <sub>KW</sub> /1239 <sub>cal/h</sub>	NET WGT 1 <sub>KG</sub>
CTN	20 <sub>PCS</sub> /20,1 <sub>KG</sub>	400x380x455 <sub>MM</sub>	LOAD 20 DC-6.200 <sub>PCS</sub> 40 HC-15.000 <sub>PCS</sub>



### SB-601 TELLİ KAMP SOBA Camping Heater with Safety Wire

MAT	Metal Body, Zinc Valve, Regulator, Ceramic Burner		
CONS	112,9 <sub>G/H</sub>	1,44 <sub>KW</sub> /1239 <sub>cal/h</sub>	NET WGT 1 <sub>KG</sub>
CTN	20 <sub>PCS</sub> /20,1 <sub>KG</sub>	400x380x455 <sub>MM</sub>	LOAD 20 DC-6.200 <sub>PCS</sub> 40 HC-15.000 <sub>PCS</sub>



### SB-620 BÜYÜK VENTİLLİ SOBA Big Heater with Safety Device

MAT	Metal Body, Zinc Valve, Regulator, Ceramic Burner		
CONS	227,3 <sub>G/H</sub>	2,9 <sub>KW</sub> /2495 <sub>cal/h</sub>	NET WGT 2 <sub>KG</sub>
CTN	5 <sub>PCS</sub> /10,1 <sub>KG</sub>	540x250x365 <sub>MM</sub>	LOAD 20 DC-2.850 <sub>PCS</sub> 40 HC-6.950 <sub>PCS</sub>



### SB-640 AYAKLI ORPORT BÜYÜK VENTİLLİ SOBA Port Big Heater With Trade And Safety Device

MAT	Metal Body, Zinc Valve, Regulator, Ceramic Burner		
CONS	227,3 <sub>G/H</sub>	2,9 <sub>KW</sub> /2495 <sub>cal/h</sub>	NET WGT 3,07 <sub>KG</sub>
CTN	4 <sub>PCS</sub> /12,36 <sub>KG</sub>	250x700x330 <sub>MM</sub>	LOAD 20 DC-2.850 <sub>PCS</sub> 40 HC-6.950 <sub>PCS</sub>



### BR-201 BÜYÜK RADYAN Big Ceramic Burner Radian

MAT	Metal Body, Zinc Valve, Regulator, Ceramic Burner		
CONS	227,3 <sub>G/H</sub>	2,9 <sub>KW</sub> /2495 <sub>cal/h</sub>	NET WGT 1,07 <sub>KG</sub>
CTN	20 <sub>PCS</sub> /21,8 <sub>KG</sub>	365x365x545 <sub>MM</sub>	



### KR-100 KÜÇÜK RADYAN Ceramic Burner Radian

MAT	Metal Body, Zinc Valve, Regulator, Ceramic Burner		
CONS	160 <sub>G/H</sub>	2 <sub>KW</sub> /1750 <sub>cal/h</sub>	NET WGT 640 <sub>G</sub>
CTN	20 <sub>PCS</sub> /13,4 <sub>KG</sub>	315x280x415 <sub>MM</sub>	



### SB-640/1 SERA SOBA Greenhouse Heater

MAT	Metal Body, Brass Valve, Ceramic Burner		
CONS	227,3 <sub>G/H</sub>	2,9 <sub>KW</sub> /2495 <sub>cal/h</sub>	NET WGT 2,27 <sub>KG</sub>
CTN	1 <sub>PCS</sub>	160x535x645 <sub>MM</sub>	LOAD 20 DC-520 <sub>PCS</sub> 40 HC-1240 <sub>PCS</sub>

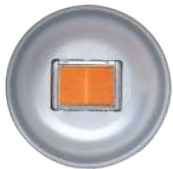



**PS-700**  
**PALMIYE SOBA**  
 Patio Heater



MAT Metal Body, Aluminium Reflector, SS Burner

CONS   
**940,4** g/h

POWER   
**12kW/10325** kcal/h  
**44.350(BTU)**

NET WGT   
**20,4** kg  
**4,3** kg

CTN   
**1** PCS  
**1** PCS

DIM   
**425x530x945** MM  
**140x830x820** MM

LOAD   
**20 DC - 100** PCS  
**40 HC - 230** PCS

GAS CATEGORY	I3B/P(30)	I3+(29-30/37)	
GAS TYPE	LPG Gas Mixture	Butan	Propan
GAS PRESSURE	30 mbar	28-30 mbar	37 mbar
TOTAL HEAT INPUT (KW) / g/h	12kW flt %10		
INJECTOR SIZE	Burner: Ø1,70mm Pilot : Ø0,19mm		



Stainless Steel Burner  
 &  
 Piezo Ignition Button



Easy to Move



Anti-Tilt Safety System





## KAMP LAMBALARI

### CAMPING LANTERN

Taşınabilir piknik tüplerinde kullanılmak üzere tasarlanmış ekonomik lambalar regülatör olmadan doğrudan her türlü standarttaki silindir tüplerde kullanılacak çeşitliliğe sahiptir.

For use in portable picnic cylinders designed economical lamps have the versatility to be used directly in cylinder tubes of any standard without a regulator.

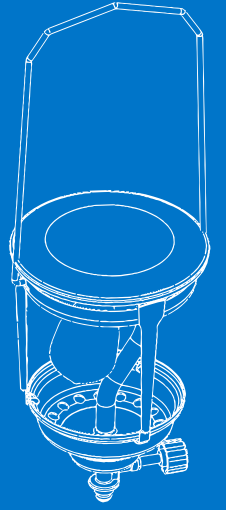



## KAMP LAMBALARI CAMPING LANTERN



### CL-190 ÇAKMAKLI KARTUŞ LAMBA Cartridge Lamp with Ignition

MAT Metal Body, Gas Mantle, Glass



CONS

43,1E<sub>9</sub>H



POWER

0,55kW/473kcal/h



NET WGT

800g



CTN

12PCS / 10,6g



DIM

380x260x565mm



### CL-192 ÇAKMAKLI KARTUŞ LAMBA Cartridge Lamp with Ignition

MAT Metal Body, Gas Mantle, Glass



CONS

43,1E<sub>9</sub>H



POWER

0,55kW/473kcal/h



NET WGT

500g



CTN

12PCS / 6,6g



DIM

215x320x370mm



### L-626 BÜYÜK LAMBA Big Lamp

MAT Metal Body, Gas Mantle, Glass



CONS

105E<sub>9</sub>H



POWER

1,34kW/1153kcal/h



NET WGT

800g



CTN

12PCS / 9,92g



DIM

315x460x440mm



### L-627 EKO BÜYÜK LAMBA Eco Big Lamp

MAT Metal Body, Gas Mantle, Glass



CONS

105E<sub>9</sub>H



POWER

1,34kW/1153kcal/h



NET WGT

780g



CTN

12PCS / 9,47g



DIM

460x310x230mm



80 CM

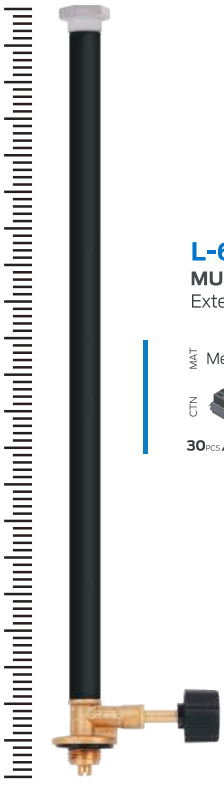

**L-640**  
MUSLUKLU UZATMA BORU  
Extension Pipe with Valve

MAT Metal Pipe, Brass Valve



CTN 30PCS / 15,12kg



DIM 855x195x155mm



NET.WGT 480g



**C-100**  
LAMBA CAMI  
Lamp Chimney



**C-200**  
LAMBA CAMI  
Lamp Chimney



**C-300**  
LAMBA CAMI  
Lamp Chimney



**F-100**  
FITİL  
Gas Mantle



**F-200**  
FITİL  
Gas Mantle



**F-300**  
FITİL  
Gas Mantle

# DEDANTÖRLER

## REGULATORS

Farklı ülkelerin farklı standartlarına göre kalite uygunlukları gösteren alternatifler sunmaktadır.

It offers alternatives showing quality conformities according to the different standards of different countries.

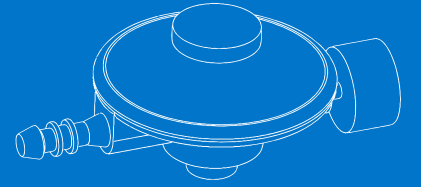





### 300-11

#### VANALI ALÇAK BASINÇ DEDANTÖRÜ Low Pressure Regulator with Valve

FEATURES	Inlet Pressure	: 0,3 - 16BAR
	Outlet Pressure	: 29mbar
	Capacity	: 0 - 1,5Kg/h
	Inlet Diameter (mm)	: W20x1.814LH(G1)
		: W21.8x1.814LH(G5)
	Outlet Diameter	: Ø10MM (H.50)



### 300-11

#### VANALI ALÇAK BASINÇ DEDANTÖRÜ Low Pressure Regulator with Valve

FEATURES	Inlet Pressure	: 0,3 - 16BAR
	Outlet Pressure	: 29mbar
	Capacity	: 0 - 1,5Kg/h
	Inlet Diameter (mm)	: W21.8x1.814LH(G12)
	Outlet Diameter	: Ø10MM (H.50)



### 300-11

#### VANALI ALÇAK BASINÇ DEDANTÖRÜ Low Pressure Regulator With Valve

FEATURES	Inlet Pressure	: 0,3 - 16BAR
	Outlet Pressure	: 29mbar
	Capacity	: 0 - 1,5Kg/h
	Inlet Diameter (mm)	: W21.8x1.814LH(G12)
	Outlet Diameter	: G1/4"LH(H.4)



### 300-11

#### VANALI ALÇAK BASINÇ DEDANTÖRÜ Low Pressure Regulator with Valve

FEATURES	Inlet Pressure	: 0,3 - 16BAR
	Outlet Pressure	: 29mbar
	Capacity	: 0 - 1,5Kg/h
	Inlet Diameter (mm)	: 0,885 - 14 NGO(G10)
	Outlet Diameter	: Ø10MM (H.50)



### 300-12

#### AYARLANABİLİR DEDANTÖR Adjustable Regulator

FEATURES	Inlet Pressure	: 0,3 - 16BAR
	Outlet Pressure	: 25-50mbar
	Capacity	: 0 - 1,5Kg/h
	Inlet Diameter (mm)	: W20x1.814LH(G1)
		: W21.8x1.814LH(G5)
	Outlet Diameter	: Ø10MM (H.50)



### ND-100

#### NUMARALI YÜKSEK BASINÇ DEDANTÖRÜ Numeric High Pressure Regulator

FEATURES	Inlet Pressure	: 0,3 - 16BAR
	Outlet Pressure	: 0 - 2mbar
	Capacity	: 0 - 8Kg/h
	Inlet Diameter (mm)	: W20x1.814LH(G1)
		: W21.8x1.814LH(G5)
	Outlet Diameter	: Ø10MM (H.50)

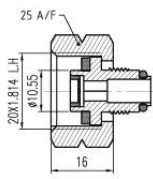

EN16129-G1

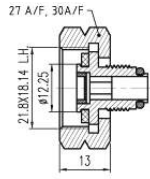

EN16129-G2

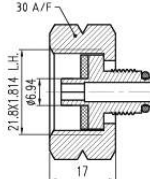

EN16129-G5

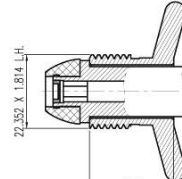

EN16129-G10

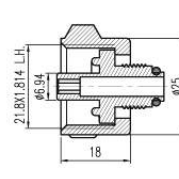

EN16129-G12

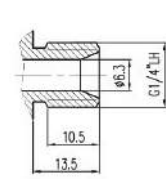

EN16129-H.4-G1/4\*LH

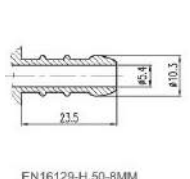

EN16129-H.50-8MM



### 300-35

#### JUMBO ALÇAK BASINÇ DEDANTÖR Jumbo Low Pressure Regulator

FEATURES	Inlet Pressure	: 0,3 - 16BAR
	Outlet Pressure	: 29mbar
	Capacity	: 0 - 1,5Kg/h
	Inlet Diameter (mm)	: Ø 35 (G.56)
	Outlet Diameter	: Ø13,5MM (H.51)



### MT-320

#### JUMBO ALÇAK BASINÇ DEDANTÖR Jumbo Low Pressure Regulator

FEATURES	Inlet Pressure	: 0,3 - 16BAR
	Outlet Pressure	: 29mbar
	Capacity	: 0 - 1,5Kg/h
	Inlet Diameter (mm)	: Ø 35 (G.56)
	Outlet Diameter	: Ø13,5MM (H.51)



### YB-350

#### JUMBO YÜKSEK BASINÇ DEDANTÖR Jumbo High Pressure Regulator

FEATURES	Inlet Pressure	: 0,3 - 16BAR
	Outlet Pressure	: 29mbar
	Capacity	: 0 - 8Kg/h
	Inlet Diameter (mm)	: Ø 35 (G.56)
	Outlet Diameter	: Ø13,5MM (H.51)



**MT-300-20**  
ALÇAK BASINÇ DEDANTÖR  
Low Pressure Regulator

FEATURES	Inlet Pressure	: 0,3 - 16BAR
	Outlet Pressure	: 29mbar
	Capacity	: 0 - 1,5Kg/h
	Inlet Diameter (mm)	: Ø16 (G.50)
	Outlet Diameter	: Ø13,5MM (H.51) Ø10MM (H.50)



**YB-150**  
YÜKSEK BASINÇLI DEDANTÖR  
High Pressure Regulator

FEATURES	Inlet Pressure	: 0,3 - 16BAR
	Outlet Pressure	: 0-2mbar
	Capacity	: 0 - 8Kg/h
	Inlet Diameter (mm)	: Ø16 (G.50)
	Outlet Diameter	: Ø10MM (H.50)



**PIK-300**  
ALÇAK BASINÇ KAMP DEDANTÖRÜ  
Low Pressure Camping Regulator

FEATURES	Inlet Pressure	: 0,3 - 16BAR
	Outlet Pressure	: 0-2mbar
	Capacity	: 0 - 8Kg/h
	Inlet Diameter (mm)	: M16 x 1,5 (G3) M14 x 1,5 (G32)
	Outlet Diameter	: Ø10MM (H.50)



**301-20**  
DÜŞÜK BASINÇLI KOMPAKT DEDANTÖR  
Compact Quick On Low Pressure Regulator

FEATURES	Inlet Pressure	: 0,3 - 16BAR
	Outlet Pressure	: 29mbar
	Capacity	: 0 - 1,5Kg/h
	Inlet Diameter (mm)	: Ø20, Ø21, Ø22, Ø27
	Outlet Diameter	: Ø10MM (H.50)



**BDS-300-20**  
METAL DEDANTÖR HORTUM SETİ  
Metal Regulator Hose Set

FEATURES	Inlet Pressure	: 0,3 - 16BAR
	Outlet Pressure	: 0 - 2mbar
	Capacity	: 0 - 8Kg/h
	Inlet Diameter (mm)	: Ø16 (G.50)
	Outlet Diameter	: Ø10MM (H.50)
	Hose	: 1,5Meter
	Hose Clamp	: 2Pcs



**BDS-300-11**  
DEDANTÖR HORTUM SETİ  
Regulator Hose Set

FEATURES	Inlet Pressure	: 0,3 - 16BAR
	Outlet Pressure	: 29mbar
	Capacity	: 0 - 1,5Kg/h
	Inlet Diameter (mm)	: W20x1.814LH(G1) W21.8x1.814LH(G5)
	Outlet Diameter	: Ø10MM (H.50)
	Hose	: 1,5Meter
	Hose Clamp	: 2Pcs



**AK-14**  
ADAPTÖR  
Adapter

FEATURES	Inlet Diameter (mm)	: M14 x 1,5
	Outlet Diameter	: 7/16 - 28 UNF



**AK-16**  
ADAPTÖR 16 mm  
Adapter 16mm

FEATURES	Inlet Diameter (mm)	: M14 x 1,5
	Outlet Diameter	: W3/4 x 1/12



**AK-716**  
ADAPTÖR  
Adapter

FEATURES	Inlet Diameter (mm)	: 7/16 - 28 UNF
	Outlet Diameter	: M14 x 1,25 (LH-g4)



# HORTUMLAR

## HOSES

Farklı ülkelerin farklı standartlarındaki gerekliliklerine uyumlu hortumlar.

Hoses compliant with the requirements of different standards of different countries.

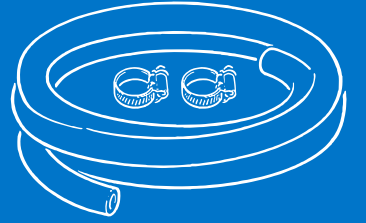



**H-808**  
DÜZ MAVİ HORTUM  
Blue LPG Hose

CTN		DIM		WGT	
50 <sub>M</sub>		310x310x180 <sub>MM</sub>		6,1 <sub>KG</sub>	
FEATURES	Product Diameter Inside	:	8MM		
	Product Diameter Outer	:	13MM		
	Weight	:	102GR/M		
	Thickness	:	2,5MM		
	Working Pressure	:	1,16BAR		
	Blasting Pressure	:	3,5BAR		



**OH-808**  
ÖRGÜLÜ MAVİ HORTUM  
Plaited Blue LPG Hose

CTN		DIM		WGT	
50 <sub>M</sub>		330x330x200 <sub>MM</sub>		6,2 <sub>KG</sub>	
FEATURES	Product Diameter Inside	:	8MM		
	Product Diameter Outer	:	14MM		
	Weight	:	122GR/M		
	Thickness	:	3MM		
	Working Pressure	:	1,16BAR		
	Blasting Pressure	:	3,5BAR		



**TH-808**  
TURUNCU SANAYİ HORTUMU  
Orange Industrial Hose

CTN		DIM		WGT	
50 <sub>M</sub>		370x370x130 <sub>MM</sub>		7,5 <sub>KG</sub>	
FEATURES	Product Diameter Inside	:	8MM		
	Product Diameter Outer	:	14MM		
	Weight	:	150GR/M		
	Thickness	:	3MM		
	Working Pressure	:	20BAR		
	Blasting Pressure	:	60BAR		



**H-810**  
DÜZ BEYAZ HORTUM  
White LPG Hose

CTN		DIM		WGT	
50 <sub>M</sub>		380x380x160 <sub>MM</sub>		7,1 <sub>KG</sub>	
FEATURES	Product Diameter Inside	:	10MM		
	Product Diameter Outer	:	16MM		
	Weight	:	142GR/M		
	Thickness	:	3MM		
	Working Pressure	:	1,16BAR		
	Blasting Pressure	:	3,5BAR		



**OH-810**  
ÖRGÜLÜ BEYAZ HORTUM  
Plaited White LPG Hose

CTN		DIM		WGT	
50 <sub>M</sub>		400x400x170 <sub>MM</sub>		7,2 <sub>KG</sub>	
FEATURES	Product Diameter Inside	:	10MM		
	Product Diameter Outer	:	16MM		
	Weight	:	142GR/M		
	Thickness	:	3MM		
	Working Pressure	:	1,16BAR		
	Blasting Pressure	:	3,5BAR		



**TH-810**  
TURUNCU SANAYİ HORTUMU  
Orange Industrial Hose

CTN		DIM		WGT	
50 <sub>M</sub>		380x380x160 <sub>MM</sub>		9 <sub>KG</sub>	
FEATURES	Product Diameter Inside	:	10MM		
	Product Diameter Outer	:	16MM		
	Weight	:	180GR/M		
	Thickness	:	3MM		
	Working Pressure	:	20BAR		
	Blasting Pressure	:	60BAR		



**HH-808**  
HARDAL MAVİ ÖRGÜLÜ HORTUM  
Ochre, Blue Plaited LPG Hose

CTN		DIM		WGT	
50 <sub>M</sub>		330x330x200 <sub>MM</sub>		7,5 <sub>KG</sub>	
FEATURES	Product Diameter Inside	:	8MM		
	Product Diameter Outer	:	14MM		
	Weight	:	122GR/M		
	Thickness	:	3MM		
	Working Pressure	:	1,16BAR		
	Blasting Pressure	:	3,5BAR		



**MH-808**  
TERMO JAVA MAVİ OKSİJEN HORTUMU  
Blue Oxygen Hose

CTN		DIM		WGT	
50 <sub>M</sub>		370x370x135 <sub>MM</sub>		7,5 <sub>KG</sub>	
FEATURES	Product Diameter Inside	:	8MM		
	Product Diameter Outer	:	14MM		
	Weight	:	150GR/M		
	Thickness	:	3MM		
	Working Pressure	:	20BAR		
	Blasting Pressure	:	60BAR		



**HH-810**  
HARDAL MAVİ ÖRGÜLÜ HORTUM  
Ochre, Blue Plaited LPG Hose

CTN		DIM		WGT	
50 <sub>M</sub>		380x380x160 <sub>MM</sub>		9 <sub>KG</sub>	
FEATURES	Product Diameter Inside	:	10MM		
	Product Diameter Outer	:	16MM		
	Weight	:	142GR/M		
	Thickness	:	3MM		
	Working Pressure	:	1,16BAR		
	Blasting Pressure	:	3,5BAR		



**MH-810**  
TERMO JAVA MAVİ OKSİJEN HORTUMU  
Blue Oxygen LPG Hose

CTN		DIM		WGT	
50 <sub>M</sub>		380x380x160 <sub>MM</sub>		9 <sub>KG</sub>	
FEATURES	Product Diameter Inside	:	10MM		
	Product Diameter Outer	:	16MM		
	Weight	:	180GR/M		
	Thickness	:	3MM		
	Working Pressure	:	20BAR		
	Blasting Pressure	:	60BAR		







### KH-808

#### TERMO JAVA KIRMIZI OKSİJEN HORTUMU

Red Oxygen LPG Hose

CTN	DİM	WGT
50	370x370x130 <sub>MM</sub>	7,5 <sub>KG</sub>

FEATURES	Product Diameter Inside	: 8MM
	Product Diameter Outer	: 14MM
	Weight	: 150 <sub>GR/M</sub>
	Thickness	: 3MM
	Working Pressure	: 20 <sub>BAR</sub>
	Blasting Pressure	: 60 <sub>BAR</sub>



### KSH-808

#### SİYAH - KIRMIZI ŞERİTLİ HORTUM

Black - Red Lined LPG Hose

CTN	DİM	WGT
50	350x350x160 <sub>MM</sub>	7,1 <sub>KG</sub>

FEATURES	Product Diameter Inside	: 8MM
	Product Diameter Outer	: 14MM
	Weight	: 122 <sub>GR/M</sub>
	Thickness	: 3MM
	Working Pressure	: 1,16 <sub>BAR</sub>
	Blasting Pressure	: 3,5 <sub>BAR</sub>



### LDK-75

#### GAZ AKTARMA HORTUMU

Gas Transfer Hose

CTN	DİM	WGT
100 <sub>PCS</sub> / 18,50 <sub>KG</sub>	405x270x410 <sub>MM</sub>	150 <sub>KG</sub>

FEATURES	Inlet Diameter (mm)	: M14 x 1,5
	Outlet Diameter	: W3/4 x 1/12



### AK-19

#### ÇELİK GAZ AKTARMA HORTUMU

Steel Gas Transfer Hose

CTN	DİM	WGT
100 <sub>PCS</sub> / 16,2 <sub>KG</sub>	285x360x195 <sub>MM</sub>	140 <sub>KG</sub>



### REKORLU BAĞLANTI HORTUMU

#### SPECIAL CONNECTION HOSE

Ürün Kodu / Code	Boy Ölçüsü (M) / Size	Diş Bağlantı Ölçüsü / Connection Measurement
H-140/14	1,40	G 1/4" (LH)
H-80/14	0,80	G 1/4" (LH)
H-40/14	0,40	G 1/4" (LH)
H-140/34	1,40	G 3/4" (LH)
H-80/34	0,80	G 3/4" (LH)
H-40/34	0,40	G 3/4" (LH)



### BH-808

#### 8'LİK LPG HORTUM SET

Lpg Hose Set Of 8

SIZE	DİM	WGT
165 <sub>MM</sub>	370x370x135 <sub>MM</sub>	200 <sub>KG</sub>
CTN		
50 <sub>PCS</sub> / 10 <sub>KG</sub>		



### K-13X19

#### KELEPÇE

Hose Clamp

CTN	DİM	WGT
1000 <sub>PCS</sub> / 8,9 <sub>KG</sub>	170x320x180 <sub>MM</sub>	0,8 <sub>KG</sub>



### K-10X16

#### KELEPÇE

Hose Clamp

CTN	DİM	WGT
1000 <sub>PCS</sub> / 9,6 <sub>KG</sub>	180x360x175 <sub>MM</sub>	0,9 <sub>KG</sub>

## MUSLUK VE BRULÖRLER

### VALVES AND BURNERS

Farklı ülkelerin farklı standart gerekliliklerine uyumlu donanım ve tüpleri için yüksek kaliteli valfler.

High quality valves for equipment and tubes complying with different standard requirements of different countries.

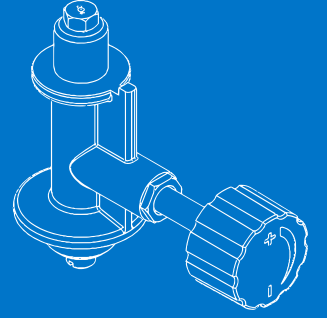





**M-700-10**  
DAR PİKNIK MUSLUK  
Narrow Stove Valve



**M-700-15**  
GENİŞ PİKNIK MUSLUK  
Wide Stove Valve

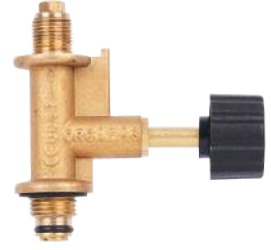

**M-700-75**  
DAR KAMP MUSLUK  
Narrow Stove Valve



**M-700-80**  
GENİŞ KAMP MUSLUK  
Wide Stove Valve

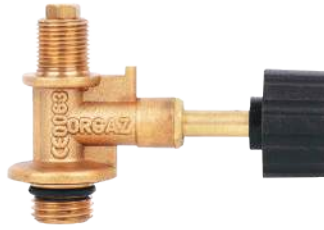

**M-900-10**  
KAMP VE LÜKS MUSLUK  
Stove And Lamp Valve

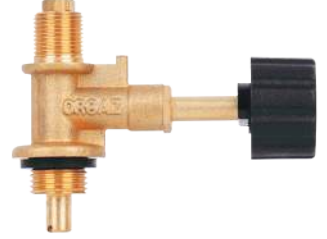

**M-500-20**  
ÇEK POL KAMP VE LÜKS MUSLUK  
Stove And Lamp Valve



**M-500-15**  
GENİŞ POL MUSLUK  
Wide Pol Valve



**M-500-10**  
DAR POL MUSLUK  
Narrow Pol Valve



**M-500-25**  
POL ÇEK MUSLUK  
Pol Check Valve

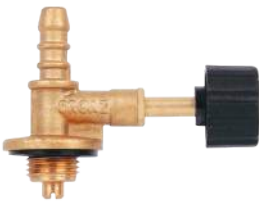

**M-700-55**  
GENİŞ HORTUM GİRİŞLİ MUSLUK  
Faucet with Wide Hose Inlet Valve



**M-700-50**  
DAR HORTUM GİRİŞLİ MUSLUK  
Narrow Hose Inlet Valve



**M-700-69**  
DİK GAZ MUSLUK  
Vertical Gas Valve



**M-700-69**  
DİK GAZ MUSLUK  
Vertical Gas Valve



**M-700-96**  
BÜYÜK SOBA MUSLUK  
Large Heater Valve



**M-700-91**  
VOLKAN OCAK MUSLUK  
Volcano Stove Valve



**M-700-95**  
ÇAY OCAK MUSLUK  
Tea Stove Valve

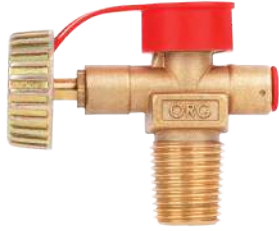

**V-100/4-5**  
PİKNİK TÜP VALFLİ VOLANLI  
Cylinders Valve



**M-40-006**  
ENJEKTÖR  
Injector



**M-40-009**  
HORTUM GİRİŞ ADAPTÖRÜ  
Hose Inlet Adapter



**SHG-100**  
SOMUN HORTUM GİRİŞİ  
Nut Hose Inlet



**ORT-8**  
8'LİK T  
T of 8



**M-40-017**  
GENİŞ MUSLUK CONTASI(26x14x2)  
Wide Tap Gasket(26x14x2)



**B-310-004**  
VİDALI DEDANTÖR CONTASI(18x11x2)  
Screwed Regulator Gasket(18x11x2)







## BRÜLÖRLER BURNERS



**B-194**  
MİKRO PREMIUM BRÜLÖR  
Micro Premium Burner



**B-627**  
ORTA BOY PREMIUM BRÜLÖR  
Medium Premium Burner



**B-628**  
BÜYÜK BOY PREMIUM BRÜLÖR  
Big Premium Burner



**B-602**  
KROM KAPLAMA BRÜLÖR  
Chrome Plated Burner



**B-605**  
SAC BRÜLÖR  
Sheet Iron Burner



**B-608**  
KROM KAPLAMA BRÜLÖR  
Chrome Plated Burner



**B-610**  
KAMP VİDALI BRÜLÖR  
Screwed Camping Burner



**B-615**  
KAMP GEÇME BRÜLÖR  
Transitive Camping Burner



**B-606**  
KARTUŞ BRÜLÖR  
Cartridge Burner



**B-606/1**  
TÜRBÜLANS KARTUŞ BRÜLÖR  
Turbulence Cartridge Burner



**B-640**  
POL BEK  
Pol Bek



**B-625**  
TURBO BRÜLÖR  
Turbo Burner



**B-638**  
SÜPER TURBO BRÜLÖR  
Super Turbo Burner



## TAV VE KAYNAK TAKIMLARI

### BLOWTORCHES and WELDING TOOLS

Orgaz yenilikçi ve gelişen teknolojilerle uygun, kullanımı kolay, güvenli ve güvenilir ürünler sunmaktadır. Kaynak takımları çok zorlu işler için yüksek güçte verimlilik sunmakta olup, farklı gaz tüpleriyle uyumludur. Farklı tipte başlıkları kusursuz uyum. Ayarlanabilir alev uzunlukları sayesinde kullanım çeşitliliği sağlamaktadır.

Orgaz offers convenient, easy-to-use, safe and reliable products with innovative and developing technologies. Welding tools offer high power efficiency for very demanding jobs and are compatible with different gas cylinders. Perfect fit with different types of heads. Adjustable flame lengths provide a variety of uses.

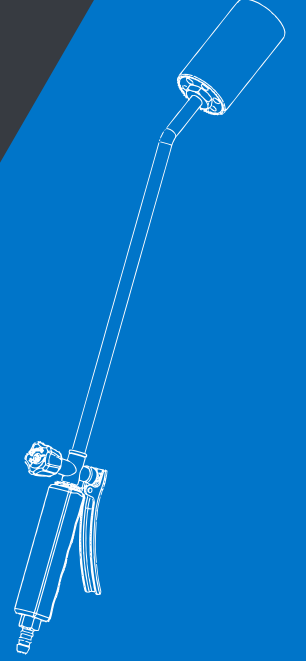





**TAV VE KAYNAK TAKIMLARI**  
BLOWTORCHES and WELDING TOOLS

**TAV VE KAYNAK TAKIMLARI** BLOWTORCHES and WELDING TOOLS



**SAP-75**

SIZE  75 CM	DIA  Ø57	CONS  4350 G/H	POWER  55,6 <sub>kW</sub> /47,850 <sub>kJ</sub> /h	BAR  0,8 <sub>BAR</sub>
---	--	--	--	---





**SAP-45**

SIZE  45 CM	DIA  Ø57	CONS  4350 G/H	POWER  55,6 <sub>kW</sub> /47,850 <sub>kJ</sub> /h	BAR  0,8 <sub>BAR</sub>
---	--	--	--	---

**SAP-33**

SIZE  33 CM	DIA  Ø48	CONS  2305 G/H	POWER  29,5 <sub>kW</sub> /30,030 <sub>kJ</sub> /h	BAR  0,8 <sub>BAR</sub>
---	--	--	--	---

**SAP-20**

SIZE  20 CM	DIA  Ø48	CONS  2305 G/H	POWER  29,5 <sub>kW</sub> /30,030 <sub>kJ</sub> /h	BAR  0,8 <sub>BAR</sub>
---	--	--	--	---

**SAP-13**

SIZE  13 CM	DIA  Ø40	CONS  1910 G/H	POWER  24,5 <sub>kW</sub> /25,355 <sub>kJ</sub> /h	BAR  0,8 <sub>BAR</sub>
---	--	--	--	---

**OTS-95**

SIZE  75 CM	DIA  Ø57	CONS  4350 G/H	POWER  55,6 <sub>kW</sub> /47,850 <sub>kJ</sub> /h	BAR  0,8 <sub>BAR</sub>
---	--	--	--	---

**OTS-90**

SIZE  45 CM	DIA  Ø57	CONS  4350 G/H	POWER  55,6 <sub>kW</sub> /47,850 <sub>kJ</sub> /h	BAR  0,8 <sub>BAR</sub>
---	--	--	--	---

**OTS-66**

SIZE  33 CM	DIA  Ø48	CONS  2305 G/H	POWER  29,5 <sub>kW</sub> /30,030 <sub>kJ</sub> /h	BAR  0,8 <sub>BAR</sub>
---	--	--	--	---

**OTS-41**

SIZE  20 CM	DIA  Ø48	CONS  2305 G/H	POWER  29,5 <sub>kW</sub> /30,030 <sub>kJ</sub> /h	BAR  0,8 <sub>BAR</sub>
---	--	--	--	---

**OTS-26**

SIZE  13 CM	DIA  Ø40	CONS  1910 G/H	POWER  24,5 <sub>kW</sub> /25,355 <sub>kJ</sub> /h	BAR  0,8 <sub>BAR</sub>
---	--	--	--	---



## OS-333

CONSUMPTION	POWER	SIZE
280 G/H 435 G/H 700 G/H	3,6 KW / 3.080 kcal/h 8,7 KW / 7.770 kcal/h 24,5 KW / 25.355 kcal/h	13 CM
DIA	BAR	
Ø22-Ø28-Ø32	0,8 BAR	

## PROPANE TORCH AND WELDING SET

### PROPAN ÜÇLÜ TAKIM

Bu sette üç yedek başlık olup çok yönlü kullanım sağlar.

Başlık ebatları 22mm, 28mm, 32mm

### PROPANE TRIPLE SET

This set includes three spare heads for versatile use.

Head sizes 22mm, 28mm, 32mm



## OS-170

CONSUMPTION	POWER	SIZE
125 G/H	1,6 KW / 1375 kcal/h	7 CM
DIA	BAR	
Ø17	0,8 BAR	



## OS-220

CONSUMPTION	POWER	SIZE
280 G/H	3,6 KW / 3080 kcal/h	13 CM
DIA	BAR	
Ø22	0,8 BAR	



## OS-280

CONSUMPTION	POWER	SIZE
435 G/H	5,55 KW / 4785 kcal/h	13 CM
DIA	BAR	
Ø28	0,8 BAR	



## OS-320

CONSUMPTION	POWER	SIZE
700 G/H	8,7 KW / 7770 kcal/h	13 CM
DIA	BAR	
Ø32	0,8 BAR	



## OS-350

CONSUMPTION	POWER	SIZE
1600 G/H	20,45 KW / 17600 kcal/h	13 CM
DIA	BAR	
Ø35	0,8 BAR	



## OS-400

CONSUMPTION	POWER	SIZE
1910 G/H	24,5 KW / 25355 kcal/h	13 CM
DIA	BAR	
Ø40	0,8 BAR	



## OS-480

CONSUMPTION	POWER	SIZE
2305 G/H	29,5 KW / 30030 kcal/h	13 CM
DIA	BAR	
Ø48	0,8 BAR	



## OS-570

CONSUMPTION	POWER	SIZE
4350 G/H	55,6 KW / 47850 kcal/h	13 CM
DIA	BAR	
Ø57	0,8 BAR	



## OH-1700

CONSUMPTION	POWER	SIZE
125 G/H	1,6 KW / 1375 kcal/h	7 CM
DIA	BAR	
Ø17	0,8 BAR	



## OH-2200

CONSUMPTION	POWER	SIZE
280 G/H	3,6 KW / 3080 kcal/h	13 CM
DIA	BAR	
Ø22	0,8 BAR	



## OH-2800

CONSUMPTION	POWER	SIZE
435 G/H	5,55 KW / 4785 kcal/h	13 CM
DIA	BAR	
Ø28	0,8 BAR	







## OH-3200

CONSUMPTION	POWER	SIZE
700 G/H	8,7 KW / 7770 kcal/h	13 CM
DIA	BAR	
Ø32	0,8 BAR	



### OH-3500

 CONSUMPTION  
**1600 G/H**  
 POWER  
**20,45 KW / 17600 kcal/h**  
 SIZE  
**13 CM**  
 DIA  
**Ø35**  
 BAR  
**0,8 BAR**







### OH-4000

 CONSUMPTION  
**1910 G/H**  
 POWER  
**24,5 KW / 25355 kcal/h**  
 SIZE  
**13 CM**  
 DIA  
**Ø40**  
 BAR  
**0,8 BAR**







### OH-4800

 CONSUMPTION  
**2305 G/H**  
 POWER  
**29,5 KW / 30030 kcal/h**  
 SIZE  
**13 CM**  
 DIA  
**Ø48**  
 BAR  
**0,8 BAR**



### OH-5700

 CONSUMPTION  
**4350 G/H**  
 POWER  
**55,6 KW / 47850 kcal/h**  
 SIZE  
**13 CM**  
 DIA  
**Ø57**  
 BAR  
**0,8 BAR**





### OB-35

 CONSUMPTION  
**1600 G/H**  
 POWER  
**17,600 kcal/h**  
 SIZE  
**28 CM**  
 DIA  
**Ø35**





### OB-32

 CONSUMPTION  
**700 G/H**  
 POWER  
**7770 kcal/h**  
 SIZE  
**23 CM**  
 DIA  
**Ø32**



### OB-28

 CONSUMPTION  
**435 G/H**  
 POWER  
**4785 kcal/h**  
 SIZE  
**22 CM**  
 DIA  
**Ø28**



### OB-22

 CONSUMPTION  
**280 G/H**  
 POWER  
**3080 kcal/h**  
 SIZE  
**15 CM**  
 DIA  
**Ø22**



### OB-17

 CONSUMPTION  
**125 G/H**  
 POWER  
**1375 kcal/h**  
 SIZE  
**10 CM**  
 DIA  
**Ø17**



### OB-40

 CONSUMPTION  
**1910 G/H**  
 POWER  
**25355 kcal/h**  
 SIZE  
**40 CM**  
 DIA  
**Ø40**



### OB-48

 CONSUMPTION  
**2305 G/H**  
 POWER  
**30030 kcal/h**  
 SIZE  
**40 CM**  
 DIA  
**Ø48**



### OB-57

 CONSUMPTION  
**4350 G/H**  
 POWER  
**47850 kcal/h**  
 SIZE  
**40 CM**  
 DIA  
**Ø57**











**Taşınabilir enerjide güvenli marka**  
Reliable brand in portable energy



#### İSTOÇ SHOWROOM

İstoç Toptancılar Çarşısı  
2418. Sk. 1. Ada No: 165-167  
Bağcılar / İSTANBUL - TÜRKİYE  
Tel: +90 212 659 90 54  
Fax: +90 212 659 90 64

#### CENTER and FACTORY

İstanbul Anadolu Yakası OSB.  
Aydınlı Mah. 1. Sk. No: 14 - 34953  
Tuzla / İSTANBUL - TÜRKİYE  
Tel: +90 216 593 13 01  
Fax: +90 216 593 13 02

#### ORCAMP OUTDOOR STORE

Fatih Mah. Katip Çelebi  
Cad. No: 4/1  
Tuzla / İstanbul / Türkiye

info@orgaz.com.tr



We are the member of  
European Customs  
Community  
By Made in TURKEY

